

TRFA01 OPERATION MANUAL

BATTERY OPERATED FUEL TRANSFER PUMP

SEE SAFETY INSTRUCTIONS
ON THE OTHER SIDE

How to Place the Batteries

Insert 4 AA batteries according to + and - signs

How to open the battery cover

Place thumb in grooves as shown in picture, push and slide the cover off in the direction of the arrow

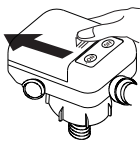

Direction of Batteries as indicated in below picture

*Replace all 4 batteries at the same time

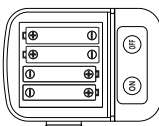

*Use the same brand/type of batteries

EMERGENCY CASES WHEN ALL (4) BATTERIES ARE NOT AVAILABLE

It is recommended to use all 4 AA batteries when you are able, but it is possible to operate with 2 AA batteries during emergencies.

*Can pump out approximately 50x 5 gallon fuel cans using 4 batteries and with 2 batteries can pump out approximately 25x 5 gallon fuel cans.

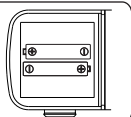

WHEN TO REPLACE THE BATTERIES

- Motor does not operate, even after pressing ON switch or transfer rate becomes slower than in normal operation.
- Batteries can begin to discharge if they are stored for a long period of time. Check the expiration dates of batteries.

How to Use

- 1 Find the adapter that is the best fit and make sure it is fastened tightly to your supply tank.

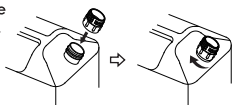
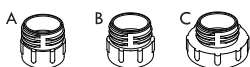

- 2 Insert intake hose through the adapter and fasten the pump's joint nut tightly.

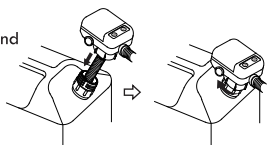

*Do not lift up or push down the pump while it is attached to the fuel tank.

- 3 Attach the discharge hose to your receiving tank using the clip, make sure the discharge nozzle is in a vertical position.

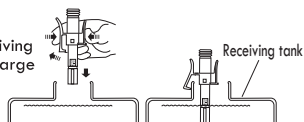

*Make sure that the supplying tank and receiving tank are on the same level when pump is operating.
*For tanks which are not fixed with the clip, make sure the discharge nozzle is vertical to the liquid level.

- 4 Start the flow of fuel by pressing the ON button.

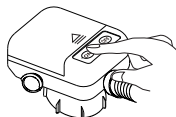

*Automatically stops when the fuel reaches the stop line.

- 5 After automatically stopping, bring the discharge hose up above the tank to drain the excess fuel or liquid back into the supply tank.

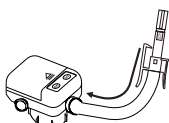

- 6 Put the discharge nozzle in discharge nozzle compartment and lock into place with clip.

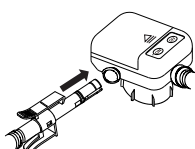

*Place the discharge nozzle into discharge nozzle compartment properly after fueling. In the event the fuel tank falls over, and the discharge hose is not in its storage hole, liquid can leak out.

NAME OF EACH PART

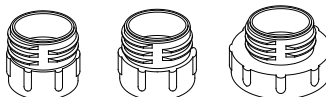
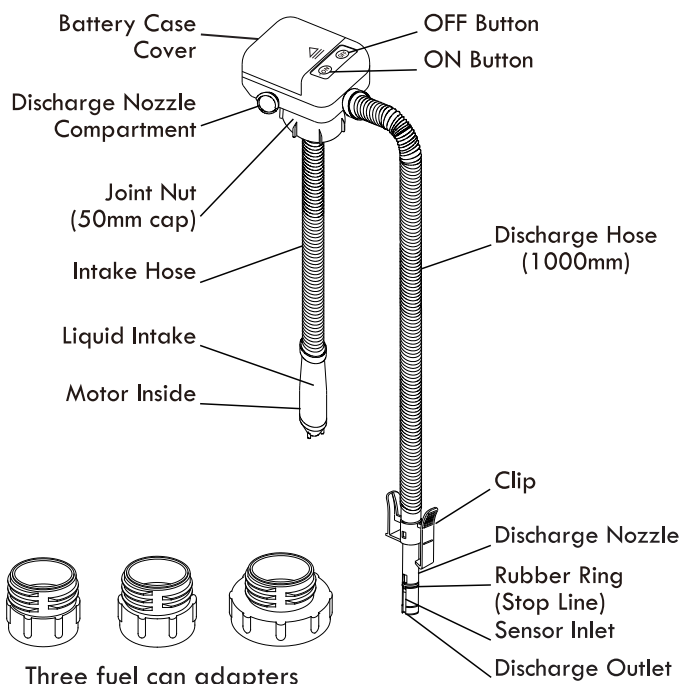

Three fuel can adapters

How to STORE

- When the pump is not being used for long periods of time, take the pump out of the tank, make sure no remaining fuel is in the hose, and wipe it down with a cloth before storing it.
- Make sure to take the batteries out before storing the pump.
- Do not store pump in enclosed airtight container.

PRODUCT SPECIFICATIONS

Model	TRFA01	Major Materials	Polypropylene, Polyethylene, Polyacetal
Battery:	AAx4 (not included)	Operating Temperature:	Approx. 5°C to 45°C
Flux:	Approx 9.2 LPM (2.4 GPM)	Compatible Liquids:	Gasoline, Kerosene, Diesel, Non-potable water
Electrical Supply:	3VDC, 3A	Pollution Degree:	2
Altitude:	2000 m	Installation Category:	I

Duty Cycle: 5 minutes run 10 minutes rest

Thank you for your purchase of the TRFA01. Please read this manual carefully to ensure proper use. Do not leave this pump unattended while in operation.



www.terapump.net
1941 E Occidental St
Santa Ana, CA 92705
support@terapump.net
1-877-251-2288



TRFA01 OPERATION MANUAL

NOT FOR DRINKING WATER

BATTERY OPERATED FUEL TRANSFER PUMP

SAFETY INSTRUCTIONS

⊘ DO NOT DO THIS

❗ YOU MUST DO THIS

- ⊘ Do not transfer fuel while vehicle or the vehicle's heater is ON (may cause a fire).
- ⊘ Do not leave the pump unattended (may cause oversupply of oil, a fire or any accident).
- ⊘ Do not alter or disassemble the pump (may cause failure of the product or an accident).
- ⊘ Do not place the pump in a wet area (may cause failure of the product or an accident).
- ⊘ Do not use deteriorated or aged fuels (these may cause our product to fail).
- ⊘ Do not use for drinkable liquids, or with thinners, solvents, hot liquid, Aceton, Benzen, Creosol, Ethyl, Phenol, Methyl ethyl, concentrated caustic soda liquid, Nitric acid, Hydrochloric acid, Sulfuric acid, etc.
- ⊘ Do not shock the pump (may cause a failure or damage of the product).
- ⊘ Do not put the product in a vehicle with all windows closed, direct sunlight area, or next to any heating appliances (may cause an accident or transform the product).
- ⊘ Do not run the pump 'dry' or let the pump idle without transferring (may cause failure of product).
- ⊘ Do not close the hole of sensor inlet. Do not supply the oil into transparent vessel under direct sunlight (may not stop automatically and overflow of liquid).
- ⊘ Do not allow children to operate the product.
- ⊘ Do not use the product on carpet, wood floor or combustible area (may cause a fire). Be careful not to damage the floor surface and/or carpet by fuel leakage.



WARNING: IMPROPER USE CAN CAUSE A DEATH OR SERIOUS INJURY

WARNING: IF THE EQUIPMENT IS USED IN A MANNER NOT SPECIFIED BY THE MANUFACTURER, A FIRE HAZARD MAY BE CAUSED



- ❗ For Adult Use Only (18+) Children should not operate.
- ❗ Make sure to press the OFF switch after each use of the pump (may cause the continual consumption of battery and leak of liquid which will cause malfunction of the product).
- ❗ Make sure the pump is tightly secured to the tank before turning the pump on.
- ❗ Make sure the sensor on the discharge nozzle is vertical (may not stop automatically, could cause fuel to overflow).
- ❗ Make sure to use the pump on even surface
(If the tank falls down during the liquid supply, liquid will leak and may cause a fire or an accident)
- ❗ Make sure remove any left-over fuel in the pump after each use (may cause of failure of the pump if fuel remains around the sensor).
- ❗ Make sure to detach the tank from the pump when moving and when storing the tank (may cause leak of fuel if moved while the tank is attached).

CAUSE OF FAILURE AND TREATMENT

SYMPTOM	CAUSE	TREATMENT
Pump does not operate even after pressing ON	<ul style="list-style-type: none">Batteries may be incorrectly placedBatteries are depleted	Ensure the batteries are placed in the pump correctly Replace the batteries
Pumps performance is low	<ul style="list-style-type: none">Batteries are depletedElevation of receiving tank is higher than supplying tank	Replace the batteries Make sure that the receiving tank is not elevated above the supply tank
Pump starts after pressing ON button but then stops unexpectedly	<ul style="list-style-type: none">Filter of receiving tank may be blocked with foreign material	Clean foreign material from the filter
Pump immediately stops after pressing the ON button	<ul style="list-style-type: none">Batteries are depleted	Replace the batteries
Motor stops before receptacle tank is full	<ul style="list-style-type: none">Batteries are depletedSensor is too low and is touching the liquid	Replace the batteries Adjust the discharge nozzle up so that the sensor is closer to the top of the supply tank

Our company shall not take any responsibility for any failure of product, malfunction and damages caused by improper use by user or third parties.



www.terapump.net
1941 E Occidental St
Santa Ana, CA 92705
support@terapump.net
1-877-251-2288



Made in Korea